

CONVOLUTED (PLEATED) FILTER DISC, RIMMED

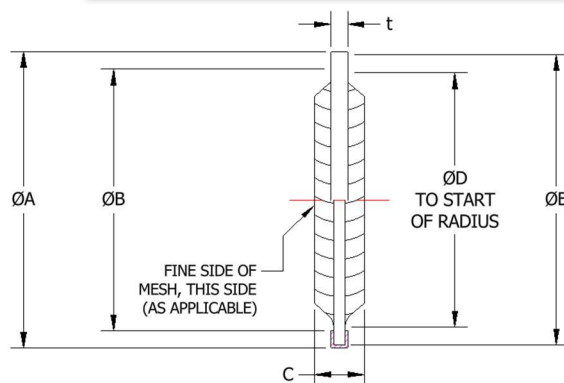
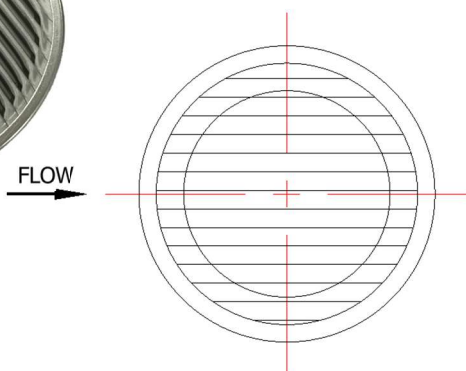

PART NUMBER DEFINITION: 84900 - 1 - 2 - (MATL)

- ADD "P" FOLLOWING MAIN PART NUMBER (84900P) FOR PASSIVATION
- STANDARD PASSIVATION: AMS 2700, METHOD 1, TYPE 2, CLASS 2
- MATERIAL: CRES PER AMS-QQ-S-763, CHEMICAL COMPOSITION ONLY
- FILTER MEDIUM: FILTER CAPABLE OF FILTERING LIQUIDS AND GASES
- FILTER MEDIA: STAINLESS STEEL WOVEN WIRE MESH
- STANDARD MATERIAL: 304 CRES
- ALTERNATE MATERIAL: 304L CRES, 316 CRES & 316L CRES
- FOR ALTERNATE MATERIAL LISTED, CONSULT FACTORY FOR AVAILABILITY

ADDITIONAL PART INFORMATION:

- MICRON RATING VERIFICATION: PARTICLE CONTROL ASSURED BY BUBBLE POINT TEST PER ARP-901, PRIOR TO MANUFACTURING
- CONVOLUTED FILTER DISC COLLAPSE PRESSURE: 50 PSID MIN
- RIMMED CONVOLUTED FILTER DISCS, ARE ULTRASONICALLY CLEANED AND BULK PACKAGED IN SEALED PLASTIC BAGS
- CONVOLUTED FILTER DISC WILL FIT INTO A "ØA" CAVITY WITH A TOLERANCE OF $\pm .005$, AFTER RIM IS SWAGED OVER DISC

PLEASE NOTE:

- ADDITIONAL NON-STANDARD DISC SIZES AVAILABLE, CONTACT OUR SALES DEPARTMENT FOR ASSISTANCE
 - ANY MODIFICATIONS TO STANDARD PART WILL BE RECLASSIFIED AS A CUSTOM PART, REQUIRING A UNIQUE PART NUMBER (NOTE: MIN OUTSIDE DIA. AVAILABLE IS Ø.320)
 - TOOLING AND SETUP CHARGES MAY VARY FOR NON-STANDARD DISC SIZES
 - CHECK FACTORY FOR LEAD TIME AND AVAILABILITY

PART NUMBER EXAMPLES: 84900P-1.020-17-316 OR 84900-645-40

Outside Dia. (ØA) 1	A $\pm .005$	B REF	C NOMINAL	D NOMINAL	E REF	Minimum Effective Filtration Area
395	.395"	.32"	.100"	.300"	.375"	.22 in ²
520	.520"	.43"	.150"	.420"	.500"	.66 in ²
645	.645"	.52"	.170"	.490"	.625"	1.00 in ²
770	.770"	.63"	.170"	.615"	.750"	1.60 in ²
1.020	1.020"	.90"	.170"	.875"	1.000"	3.25 in ²
1.395	1.395"	1.29"	.170"	1.250"	1.375"	6.60 in ²
1.520	1.520"	1.42"	.170"	1.375"	1.500"	8.00 in ²

CONVOLUTED (PLEATED) FILTER DISC, RIMMED



PART NUMBER DEFINITION: 84900 - 1 - 2 - (MATL)

Micron 2	Thickness t MAX	When Filtering Liquids		When Filtering Gasses	
		Nominal Micron 98% Removal	Absolute Micron 100% Removal	Nominal Micron 98% Removal	Absolute Micron 100% Removal
02	.04"	2	15	1	9
05	.06"	5	18	3.5	13
10	.06"	10	25	6	18
17	.06"	17	45	11	25
40	.08"	40	65	30	55
70	.08"	70	105	50	85
105	.08"	105	150	85	130
145	.08"	145	205	120	175
250	.09"	250	350	200	300